



Sunset Way, Evesham, WR11 3JX

Property Description

This three-bedroom semi-detached home is located on the popular The Orchards development in Evesham, offering contemporary accommodation ideal for families, first-time buyers, or investors.

The property opens into a welcoming entrance hall with access to a convenient ground floor WC, followed by a well-appointed kitchen to the front. At the rear, the spacious lounge provides a bright and comfortable living area with views over the garden and space for dining.

Upstairs, the property offers three well-proportioned bedrooms, including a main bedroom with en-suite shower room. A stylish family bathroom serves the remaining bedrooms.

Externally, the property benefits from driveway parking to the side for two vehicles. The rear garden is mainly laid to lawn, enclosed by fencing, and features a patio area along with side access leading directly to the parking, ideal for everyday practicality and outdoor enjoyment.





Key Features

- MODERN THREE BEDROOM SEMI-DETACHED HOME
- POPULAR THE ORCHARDS DEVELOPMENT
- ENTRANCE HALL WITH GROUND FLOOR WC
- FITTED KITCHEN
- SPACIOUS LOUNGE OVERLOOKING THE GARDEN
- MAIN BEDROOM WITH EN-SUITE SHOWER ROOM
- FAMILY BATHROOM
- DRIVEWAY PARKING FOR TWO VEHICLES
- REAR GARDEN WITH LAWN, PATIO & SIDE ACCESS TO PARKING
- EPC RATING = B

Asking Price
£280,000



Ground Floor

Approx. 37.5 sq. metres (403.8 sq. feet)

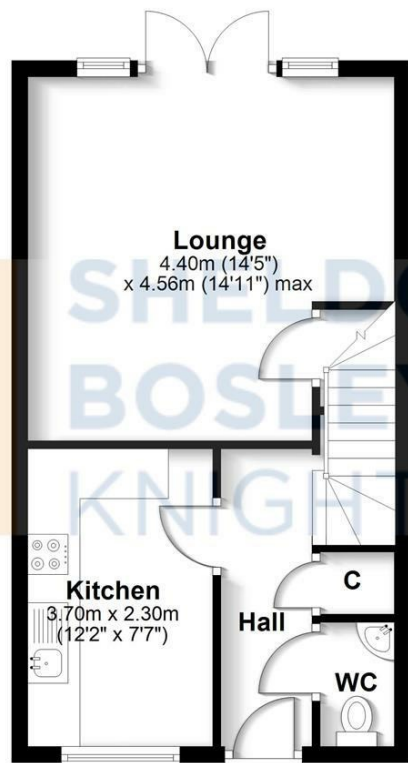

First Floor

Approx. 37.6 sq. metres (405.1 sq. feet)

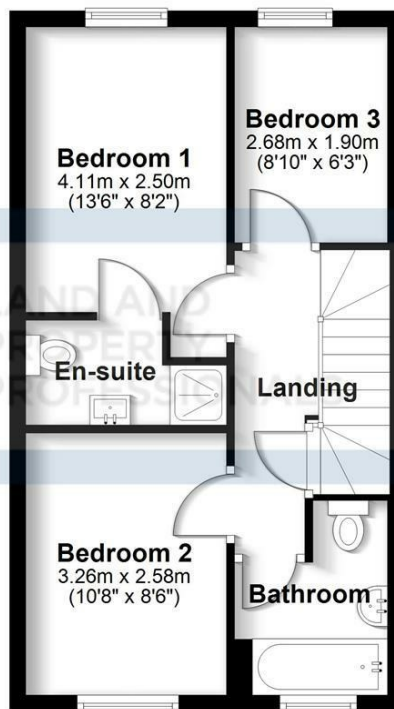

Total area: approx. 75.1 sq. metres (808.9 sq. feet)

All efforts have been made to ensure the measurements are accurate on this floor plan, however these are for guidance purposes only.

Plan produced using PlanUp.



EPC Rating - B

Tenure - Freehold

Council Tax Band - C

Local Authority
Wychavon District Council



We routinely refer clients to both our recommended legal firm and a panel of financial services providers. It is your decision whether you choose to deal with these companies. In making that decision, you should know that we receive a referral fee.

**SHELDON
BOSLEY
KNIGHT**

LAND AND
PROPERTY
PROFESSIONALS